



# Acoustic Room Details

## Preinstallation Requirements for MR Systems

5850262-1EN  
Revision 8

# Language Policy

## DOC0371395 - Global Language Procedure

ПРЕДУПРЕЖ ДЕНИЕ (BG)	Това ръководство е налично само на китайски (ZH-CN), английски, френски, немски, японски, корейски, полски, португалски (PT-BR), руски, испански и виетнамски. Ако доставчикът на услуги на даден клиент изисква език, който е различен от тези езици, отговорност на клиента е да предостави преводачески услуги.
警告 (ZH-CN)	本手册仅提供中文 (ZH-CN)、英文、法语、德语、意大利语、日语、韩语、波兰语、葡萄牙语 (PT-BR)、俄语、西班牙语和越南语版本。如果客户的服务提供商需要其他语言，则客户有责任提供翻译服务。
警告 (ZH-HK)	本手冊僅提供中文 (ZH-CN)、英文、法文、德文、意大利文、日文、韓文、波蘭文、葡萄牙文 (PT-BR)、俄文、西班牙文及越南文版本。如客戶的服務供應商需要這些語言以外的版本，則相關客戶有責任提供有關的翻譯服務。
警告 (ZH-TW)	此手冊僅提供中文 (ZH-CN)、英文、法文、德文、義大利文、日文、韓文、波蘭文、葡萄牙文 (PT-BR)、俄文、西班牙文和越南文版本。假如客戶的服務提供者所需語言版本不在所列語言之中，客戶需自行負責提供翻譯服務。
UPOZORENJE (HR)	Ovaj je priručnik dostupan samo na kineskom (ZH-CN), engleskom, francuskom, njemačkom, talijanskom, japanskom, korejskom, poljskom, portugalskom (PT-BR), ruskom, španjolskom i vijetnamskom jeziku. Ako klijentov serviser zahtijeva jezik koji nije jedan od tih jezika, odgovornost je klijenta pružiti uslugu prevođenja.
VÝSTRAHA (CS)	Tato příručka je k dispozici pouze v čínštině (ZH-CN), angličtině, francouzštině, němčině, italštině, japonštině, korejštině, polštině, portugalštině (PT-BR), ruštině, španělštině a vietnamštině. Pokud poskytovatel služeb zákazníka vyžaduje jiný jazyk než tyto jazyky, je odpovědností zákazníka poskytovat překladatelské služby.
ADVARSEL (DA)	Denne vejledning findes kun på kinesisk (ZH-CN), engelsk, fransk, tysk, italiensk, japansk, koreansk, polsk, portugisisk (PT-BR), russisk, spansk og vietnamesisk. Hvis en kundes tjenesteudbyder kræver et andet sprog end disse sprog, er det kundens ansvar at levere oversættelsestjenester.
WAARSCHUWING (NL)	Deze handleiding is alleen beschikbaar in het Chinees (ZH-CN), Engels, Frans, Duits, Italiaans, Japans, Koreaans, Pools, Portugees (PT-BR), Russisch, Spaans en Vietnamees. Als de serviceprovider van een klant een andere taal dan deze talen vereist, is het de verantwoordelijkheid van de klant om vertaalservices te leveren.
WARNING (EN)	This manual is available in Chinese (ZH-CN), English, French, German, Italian, Japanese, Korean, Polish, Portuguese (PT-BR), Russian, Spanish, and Vietnamese only. If a customer's service provider requires a language other than these languages, it is the customer's responsibility to provide translation services.
HOIATUS (ET)	See juhend on saadaval ainult hiina (ZH-CN), inglise, prantsuse, saksa, itaalia, jaapani, korea, poola, portugali (PT-BR), vene, hispaania ja vietnami keeles. Kui kliendi teenusepakkujal on vaja juhendit mõnes muus keeles, on tõlketeenuste osutamine kliendi kohustus.
VAROITUS (FI)	Tämä opas on saatavilla vain kiinaksi (ZH-CN), englanniksi, ranskaksi, saksaksi, italiaksi, japaniksi, koreaksi, puolaksi, portugaliksi (PT-BR), venäjäksi, espanjaksi ja vietnamiksi. Jos asiakkaan palveluntarjoaja edellyttää muuta kuin näitä kieliä, käännöspalveluiden tarjoaminen on asiakkaan vastuulla.
ATTENTION (FR)	Ce manuel est disponible uniquement en allemand, anglais, chinois (ZH-CN), coréen, espagnol, français, italien, japonais, polonais, portugais (PT-BR), russe et vietnamien. Si le prestataire de services d'un client nécessite que le manuel soit rédigé dans une autre langue que celles mentionnées ci-dessus, il incombe au client de le faire traduire.
WARNUNG (DE)	Dieses Handbuch ist nur auf Chinesisch (ZH-CN), Englisch, Französisch, Deutsch, Italienisch, Japanisch, Koreanisch, Polnisch, Portugiesisch (PT-BR), Russisch, Spanisch und Vietnamesisch verfügbar. Wenn ein Dienstleister des Kunden dieses in einer anderen Sprache als die genannten benötigt, liegt es in der Verantwortung des Kunden, Übersetzungsdienstleistungen zu erbringen.

ΠΡΟΕΙΔΟΠΟΙΗΣΗ (EL)	Αυτό το εγχειρίδιο είναι διαθέσιμο μόνο σε Κινεζικά (ZH-CN), Αγγλικά, Γαλλικά, Γερμανικά, Ιταλικά, Ιαπωνικά, Κορεατικά, Πολωνικά, Πορτογαλικά (PT-BR), Ρωσικά, Ισπανικά και Βιετναμέζικα. Εάν ο πάροχος υπηρεσιών ενός πελάτη απαιτεί γλώσσα που δεν συμπεριλαμβάνεται σε αυτές τις γλώσσες, αποτελεί ευθύνη του πελάτη να παρέχει υπηρεσίες μετάφρασης.
FIGYELMEZTETÉS (HU)	Ez a kézikönyv az alábbi nyelveken érhető el: angol, francia, japán, kínai (ZH-CN), koreai, lengyel, német, olasz, orosz, portugál (PT-BR), spanyol és vietnámi. Ha az ügyfél szolgáltatója ezektől eltérő nyelvű kézikönyvet szeretne, akkor az ügyfél feladata, hogy gondoskodik a megfelelő fordításról.
AÐVÖRUN (IS)	Þessi handbók er aðeins fánleg á kínversku (ZH-CN), ensku, frönsku, þýsku, ítölsku, japönsku, kóresku, pólsku, portúgölsku (PT-BR), rússnesku, spænsku og víetnömsku. Ef þjónustuaðili viðskiptavinar þarfnast annars tungumáls en þessara tungumála er það á ábyrgð viðskiptavinarins að veita þýðingarþjónustu.
AVVERTENZA (IT)	Questo manuale è disponibile solo in lingua cinese (ZH-CN), inglese, francese, tedesco, italiano, giapponese, coreano, polacco, portoghese (PT-BR), russo, spagnolo e vietnamita. Qualora un fornitore di servizi del cliente richieda una lingua diversa dall'inglese, sarà responsabilità del cliente fornire il servizio di traduzione corrispondente.
警告 (JA)	このマニュアルは、中国語 (ZH-CN)、英語、フランス語、ドイツ語、イタリア語、日本語、韓国語、ポーランド語、ポルトガル語 (PT-BR)、ロシア語、スペイン語、およびベトナム語のみで提供されています。お客様のサービスプロバイダがこれらの言語以外の言語を必要とする場合は、お客様の責任において翻訳サービスを提供してください。
경고 (KO)	이 설명서는 중국어(중국어-중국), 영어, 프랑스어, 독일어, 이탈리아어, 일본어, 한국어, 폴란드어, 포르투갈어(포르투갈어-브라질), 러시아어, 스페인어, 베트남어로만 제공됩니다. 고객의 서비스 제공자가 이 언어를 제외한 다른 언어를 요구하는 경우, 번역 서비스를 제공하는 것은 고객의 책임입니다.
BRĪDINĀJUMS (LV)	Šī rokasgrāmata ir pieejama tikai ķīniešu (ZH-CN), angļu, franču, vācu, itāliešu, japāņu, korejiešu, poļu, portugāļu (PT-BR), krievu, spāņu un vjetnamiešu valodā. Ja klientu apkalpošanas speciālistam ir nepieciešama cita valoda, kas atšķiras no šeit norādītajām, klienta pienākums ir nodrošināt tulkotājas pakalpojumu.
ĮSPĖJIMAS (LT)	Šis vadovas pateikiamas tik kinų (ZH-CN), anglų, prancūzų, vokiečių, italų, japonų, korėjiečių, lenkų, portugalų (PT-BR), rusų, ispanų ir vietnamiečių kalbomis. Jei klientų paslaugų teikėjui reikalinga kita nei šios kalba, už vertimo paslaugų suteikimą atsako klientas.
ADVARSEL (NO)	Denne håndboken er bare tilgjengelig på kinesisk (ZH-CN), engelsk, fransk, tysk, italiensk, japansk, koreansk, polsk, portugisisk (PT-BR), russisk, spansk og vietnamesisk. Hvis en kundes tjenesteleverandør krever et annet språk, er det kundens ansvar å levere en oversettelsestjeneste.
OSTRZEŻENIE (PL)	Niniejsza instrukcja jest dostępna wyłącznie w języku chińskim (ZH-CN), angielskim, francuskim, niemieckim, włoskim, japońskim, koreańskim, polskim, portugalskim (PT-BR), rosyjskim, hiszpańskim i wietnamskim. Jeśli usługodawca klienta wymaga języka, który nie został wymieniony powyżej, obowiązkiem klienta jest zapewnienie usług tłumaczeniowych.
ATENÇÃO (PT-BR)	Este manual está disponível somente em chinês (ZH-CN), inglês, francês, alemão, italiano, japonês, coreano, polonês, português (PT-BR), russo, espanhol e vietnamita. Se o prestador de serviços de um cliente necessitar de um idioma diferente dos mencionados, o fornecimento dos serviços de tradução é de responsabilidade do cliente.
ATENÇÃO (PT-PT)	Este manual está disponível apenas em alemão, chinês (ZH-CN), coreano, espanhol, francês, inglês, italiano, japonês, polaco, português (PT-BR), russo e vietnamita. Se o fornecedor de serviços de um cliente necessitar de um idioma diferente dos listados aqui, é da responsabilidade do cliente assegurar os serviços de tradução.
ATENȚIE (RO)	Acest manual este disponibil numai în limbile chineză (ZH-CN), engleză, franceză, germană, italiană, japoneză, coreeană, poloneză, portugheză (PT-BR), rusă, spaniolă și vietnameză. Dacă furnizorul de servicii al unui client solicită o limbă diferită față de aceste limbi, este responsabilitatea clientului să furnizeze servicii de traducere.

ОСТОРОЖНО! (RU)	Настоящее руководство доступно только на китайском (ZH-CN), английском, французском, немецком, итальянском, японском, корейском, польском, португальском (PT-BR), русском, испанском и вьетнамском языках. Если поставщику услуг заказчика требуется руководство на каком-либо другом языке, перевод руководства на необходимый язык осуществляется стороной заказчика.
UPOZORENJE (SR)	Ovaj priručnik dostupan je samo na kineskom (ZH-CN), engleskom, francuskom, nemačkom, italijanskom, japanskom, korejskom, poljskom, portugalskom (PT-BR), ruskom, španskom i vijetnamskom jeziku. Ako korisnik kao pružalac usluge zahteva neki drugi jezik od navedenih, njegova je dužnost da obezbedi prevod.
UPOZORNENIE (SK)	Táto príručka je dostupná len v nasledovných jazykoch: čínština (ZH-CN), angličtina, francúzština, nemčina, taliančina, japončina, kórejščina, poľština, portugalčina (PT-BR), ruština, španielčina a vietnamčina. Ak poskytovateľ služieb daného zákazníka požaduje iný ako tieto jazyky, za poskytnutie prekladateľských služieb zodpovedá zákazník.
ATENCIÓN (ES)	Este manual está disponible solo en chino (ZH-CN), inglés, francés, alemán, italiano, japonés, coreano, polaco, portugués (PT-BR), ruso, español y vietnamita. Si el proveedor de servicios de un cliente requiere un idioma distinto de estos idiomas, es responsabilidad del cliente proporcionar los servicios de traducción.
VARNING (SV)	Den här manualen finns endast tillgänglig på kinesiska (ZH-CN), engelska, franska, tyska, italienska, japanska, koreanska, polska, portugisiska (PT-BR), ryska, spanska och vietnamesiska. Om en kunds tjänsteleverantör behöver ett annat språk än dessa är det kundens ansvar att ordna med översättningstjänster.
OPOZORILO (SL)	Ta priručnik je na voljo v kitajščini (ZH-CN), angleščini, francoščini, nemščini, italijanščini, japonščini, korejščini, poljščini, portugalščini (PT-BR), ruščini, španščini in vietnamščini. Če kupčev ponudnik storitev potrebuje drug jezik, mora za prevod poskrbeti kupec.
DİKKAT (TR)	Bu kılavuz yalnızca Çince (ZH-CN), İngilizce, Fransızca, Almanca, İtalyanca, Japonca, Korece, Lehçe, Portekizce (PT-BR), Rusça, İspanyolca ve Vietnamca dillerinde mevcuttur. Müşteri servis sağlayıcısı bu dillerden başka bir dil talep ederse çeviri hizmeti sağlamak müşterinin sorumluluğundadır.
ЗАСТЕРЕЖЕННЯ (UK)	Цей посібник доступний лише китайською (ZH-CN), англійською, французькою, німецькою, італійською, японською, корейською, польською, португальською (PT-BR), російською, іспанською та в'єтнамською мовами. Якщо постачальник послуг замовника використовує мову, яку не вказано у цьому переліку, послуги з перекладу має забезпечити замовник.

# Contents

<b>1 Introduction</b> .....	<b>6</b>
1.1 Who Should Read This Manual .....	6
1.2 Purpose.....	6
<b>2 Acoustic Specifications</b> .....	<b>7</b>
2.1 MR Suite Acoustic Specifications.....	7
2.2 Magnet Room Acoustic Specifications .....	7
<b>3 Acoustic Background and Design Guidelines</b> .....	<b>15</b>
3.1 Acoustic Background .....	15
3.2 Airborne Acoustic Background .....	15
3.3 Structure-borne Acoustic Background.....	15
3.4 Acoustic Design Guidelines for the Magnet Room .....	16
3.5 Acoustic Design Guidelines for Inter-spacial Areas.....	16
3.6 Wall Construction .....	16
3.7 High Bay RF Room .....	18
3.8 Miscellaneous Plumbing, RF Windows and RF Doors.....	18
<b>Revision History</b> .....	<b>19</b>

# 1 Introduction

## 1.1 Who Should Read This Manual

The following personnel must be aware of the contents of this manual:

Icon	Personnel
	Architect

## 1.2 Purpose

The purpose of this document is to provide the MR site contractor with the needed information on how to create an MR suite that will meet the acoustic requirements for the MR scanners. This information was previously located in the system Preinstallation Manual. Since acoustic requirements are similar for the different GE HealthCare MR Systems, this manual will apply to all new production GE HealthCare MR Systems. A building acoustics expert can be consulted during the design process, if needed.

## 2 Acoustic Specifications

### 2.1 MR Suite Acoustic Specifications

The following table lists the acoustic output of GE HealthCare equipment:

**Table 2-1 Acoustic Specifications (Under Ambient Conditions)**

Room	GE HealthCare Equipment Acoustic Output
Control Room	≤ 62 dBA <sup>1</sup>
Equipment Room	≤ 83 dBA (For <b>SIGNA Prime, SIGNA Victor, SIGNA Aviator AIR and SIGNA Star AIR, SIGNA Prime Max, SIGNA Prime Elite</b> ) ≤ 83.6 dBA (For <b>SIGNA Bolt, SIGNA Premier, SIGNA MAGNUS, SIGNA 7.0T, SIGNA Sprint</b> ) ≤ 80 dBA (For all other systems)
Magnet Room	See <a href="#">2.2 Magnet Room Acoustic Specifications on page 7</a>
1. For SIGNA Creator/Explorer/MR355/MR360/MR380 systems: when equipment room and control room are combined, refer to equipment room for Acoustic output.	

#### NOTE

All GE HealthCare equipment acoustic output values are for base equipment configuration in each room.

1. The customer must use acoustic noise containment solutions to control leakage of acoustic noise from one room to the next. See [Acoustic Background and Design Guidelines on page 15](#) for guidance to contain the noise within the Magnet Room.
2. The level indicated for Equipment Room in [Table 2-1 Acoustic Specifications \(Under Ambient Conditions\)](#) is for GE HealthCare equipment only. The Equipment Room acoustic level must not exceed 85 dBA.

### 2.2 Magnet Room Acoustic Specifications

The acoustic room is a layer used to help contain the noise (within the Magnet Room) which is produced during clinical scanning. The following information is provided for the acoustic engineer to design for acoustic noise containment.

**Table 2-2 Acoustic Specifications for the Magnet Room**

Location	Maximum Sound Pressure Level <sup>1</sup>	Frequency Distribution <sup>2</sup>
Magnet Bore	<p><b>(For all 1.5T systems except SIGNA Artist Evo or SIGNA Sprint) 122 dBA</b></p> <p><b>(For SIGNA Artist Evo) 124 dBA</b></p> <p><b>(For all 3.0T systems and 1.5T SIGNA Sprint) 128 dBA</b></p> <p><b>(For all 7.0T systems) 128 dBA</b></p>	See the <i>Sound Pressure Spectral Distribution</i> figure below for the applicable system.
Front of Magnet - 800 mm from bore opening	Magnet Bore – 4 dBA	
<p>Notes:</p> <ol style="list-style-type: none"> <li>The magnet bore specification is based on the worst case or 20-second average acoustic noise. An 8-hour average will be much less.</li> <li>The total energy, SPL, is derived through the log sum of each 1/3 band octave totaling 128 dBA (for 3.0T magnets) or 122 dBA (for 1.5T magnets). That is, the maximum single 1/3 band is lower than the published values at the front of the magnet.</li> </ol>		

**Figure 2-1 Sound Pressure Spectral Distribution (Normalized for 20 Hz SPL as 1 dBA) (For 3.0T: SIGNA Architect, SIGNA PET/MR, Discovery MR750w)**

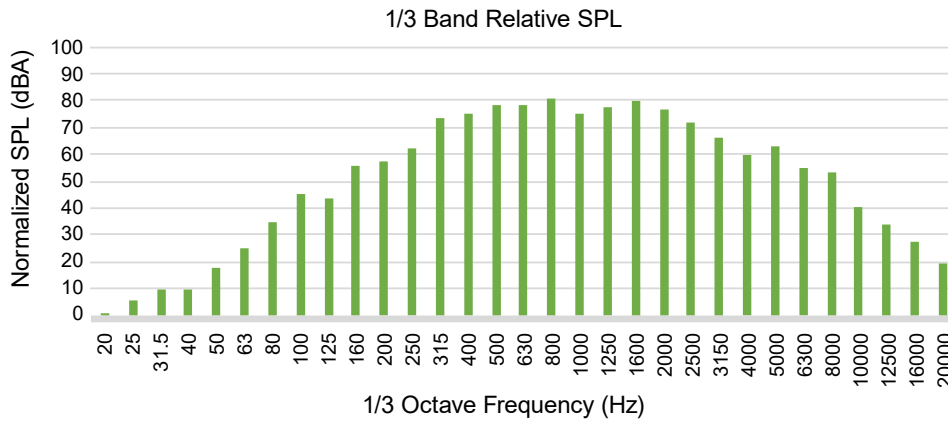

**Figure 2-2 Sound Pressure Spectral Distribution (Normalized for 25 Hz SPL as 1 dBA) (For 3.0T: SIGNA Pioneer, SIGNA Hero, SIGNA Performer, SIGNA Pilot)**

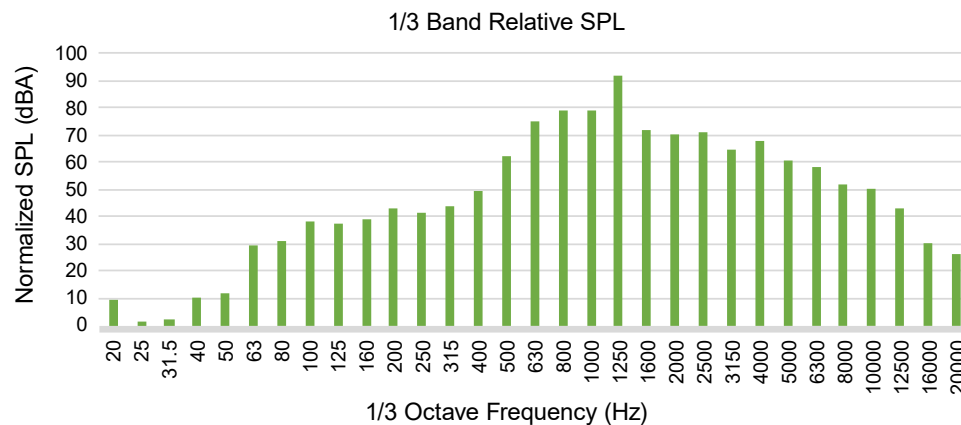

**Figure 2-3 Sound Pressure Spectral Distribution (Normalized for 20 Hz SPL as 1 dBA) (For 3.0T: SIGNA Premier, SIGNA MAGNUS and 7.0T: SIGNA 7.0T)**

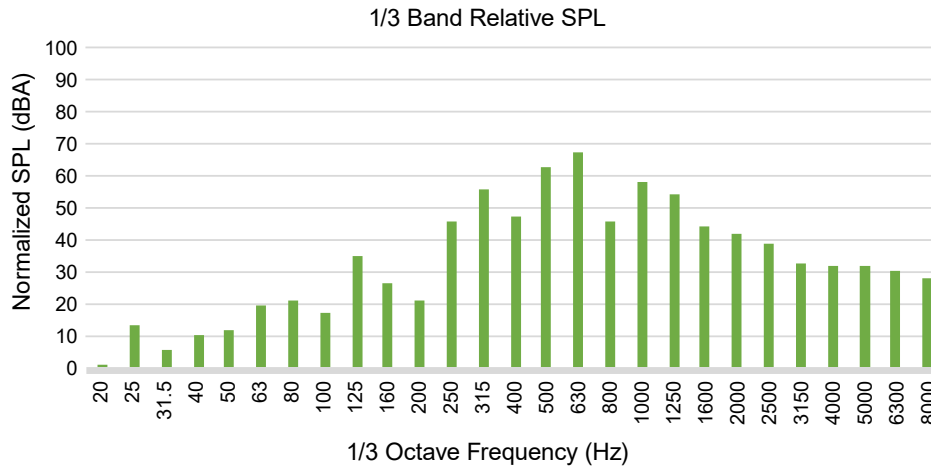

**Figure 2-4 Sound Pressure Spectral Distribution (Normalized for 20 Hz SPL as 1 dBA) (For 3.0T: SIGNA Bolt)**

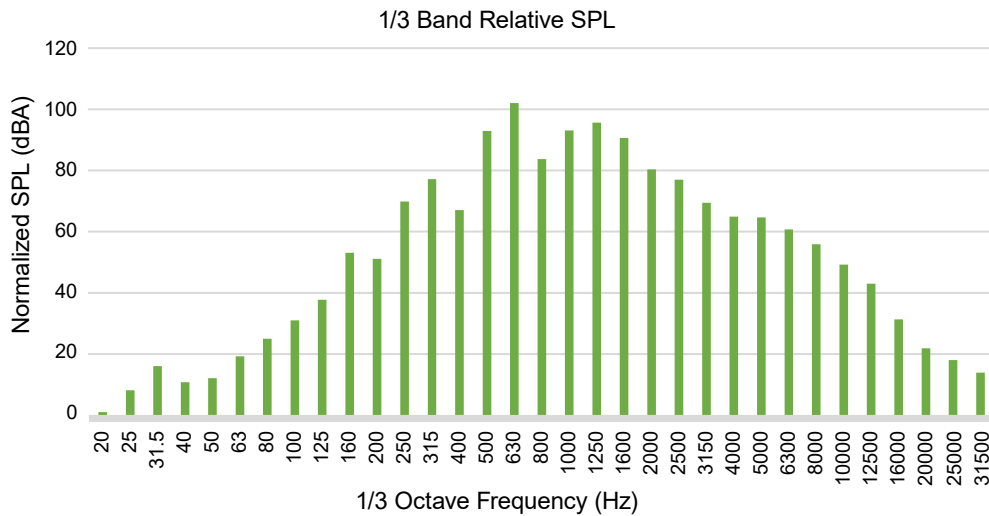

**Figure 2-5 Sound Pressure Spectral Distribution (Normalized for 25 Hz SPL as 1 dBA) (For 1.5T: SIGNA Creator/Explorer/MR355/MR360/MR380)**

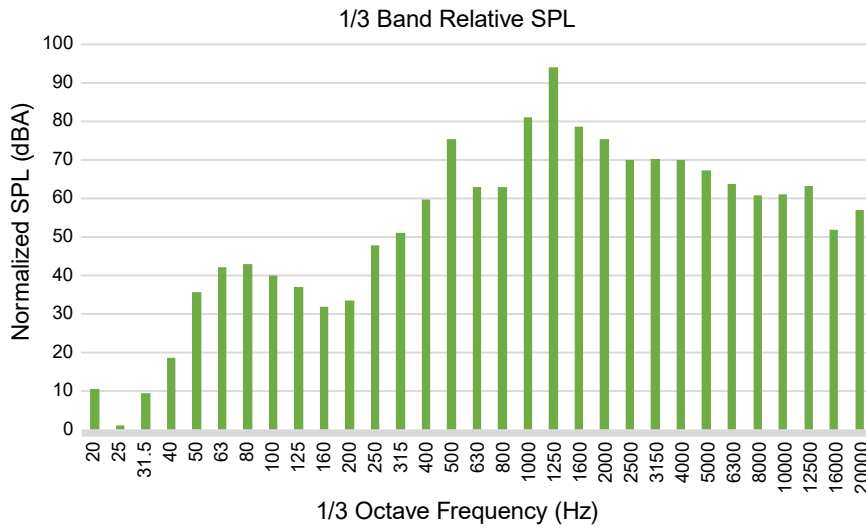

**Figure 2-6 Sound Pressure Spectral Distribution (Normalized for 20 Hz SPL as 1 dBA) (For 1.5T: SIGNA Prime)**

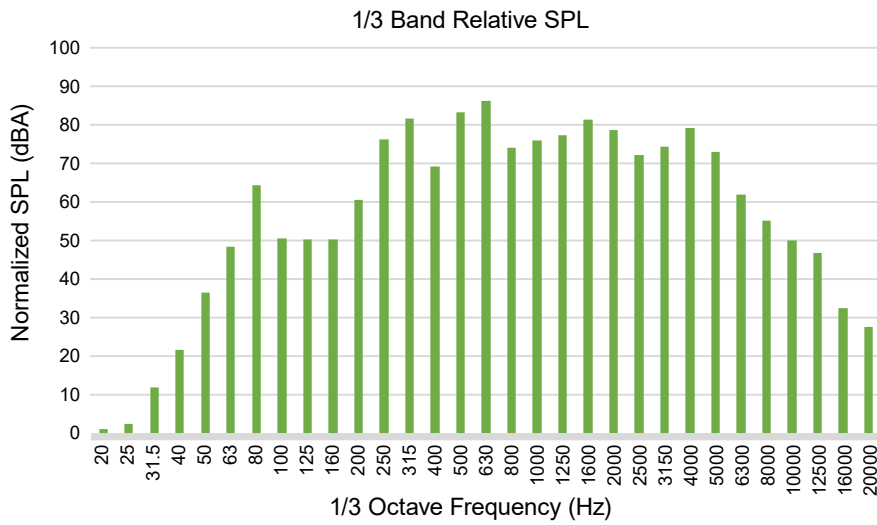

**Figure 2-7 Sound Pressure Spectral Distribution (Normalized for 25 Hz SPL as 1 dBA) (For 1.5T: SIGNA Prime MAX/SIGNA Prime Elite)**

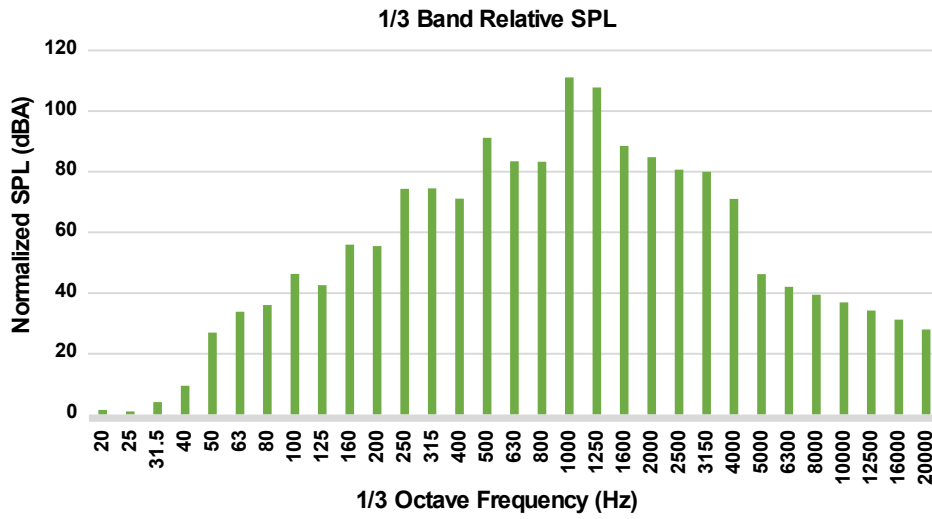

**Figure 2-8 Sound Pressure Spectral Distribution (Normalized for 20 Hz SPL as 1 dBA) (For 1.5T: SIGNA Victor/SIGNA Aviator AIR/SIGNA Star AIR)**

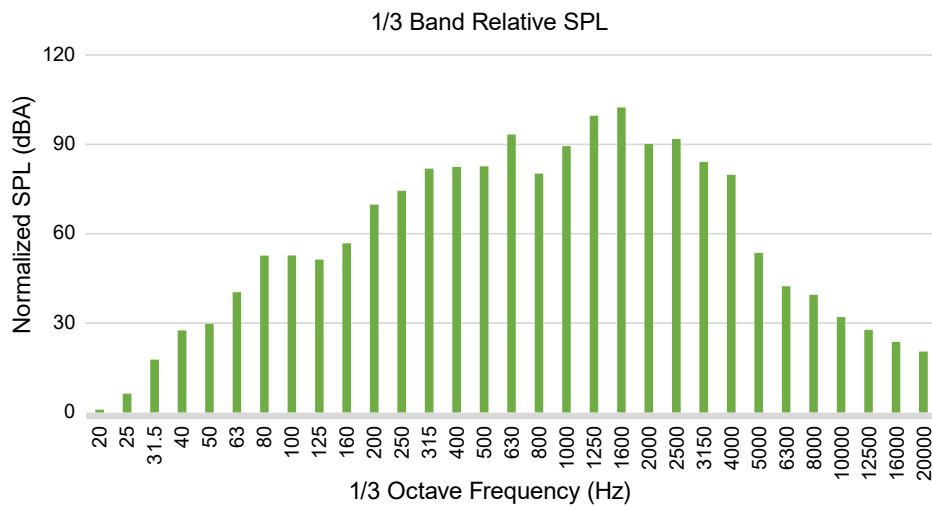

**Figure 2-9 Sound Pressure Spectral Distribution (Normalized for 31.5 Hz SPL as 1 dBA) (For 1.5T: SIGNA Artist, Optima 450w)**

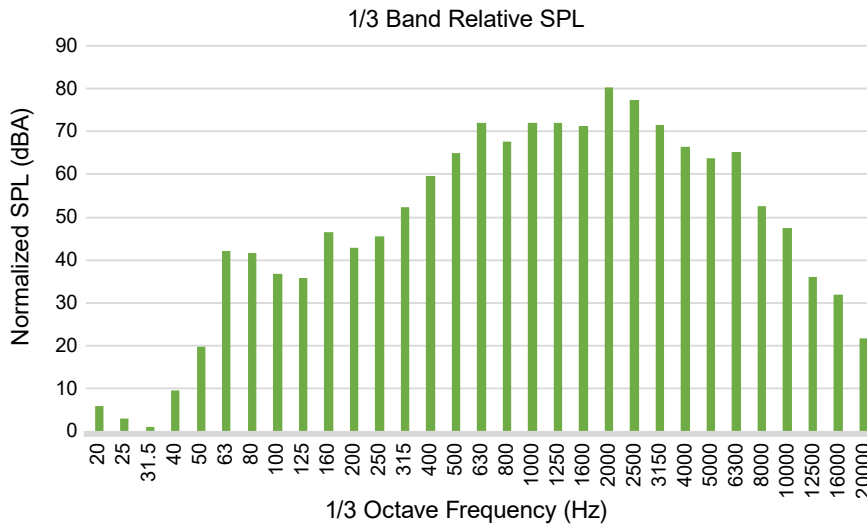

**Figure 2-10 Sound Pressure Spectral Distribution (Normalized for 20 Hz SPL as 1 dBA) (For 1.5T: SIGNA Artist Evo)**

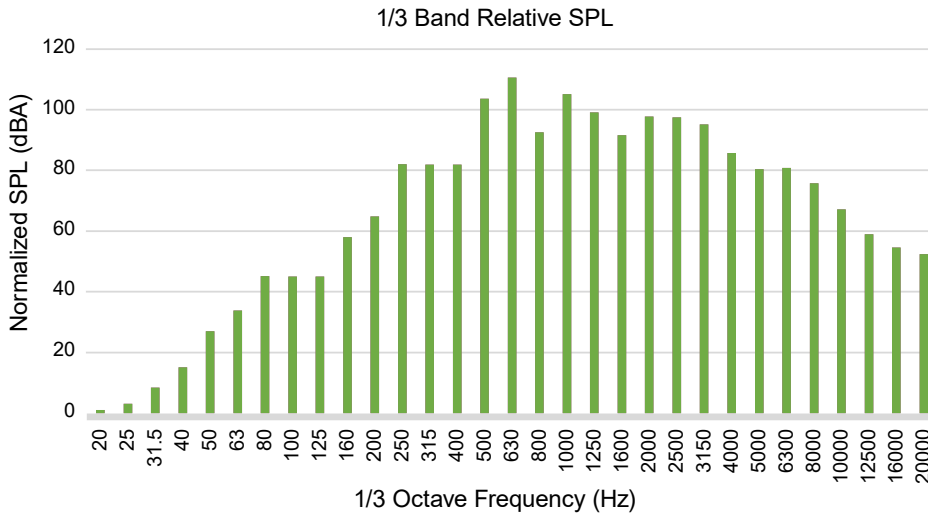

**Figure 2-11 Sound Pressure Spectral Distribution (Normalized for 25 Hz SPL as 1 dBA) (For 1.5T: SIGNA Voyager)**

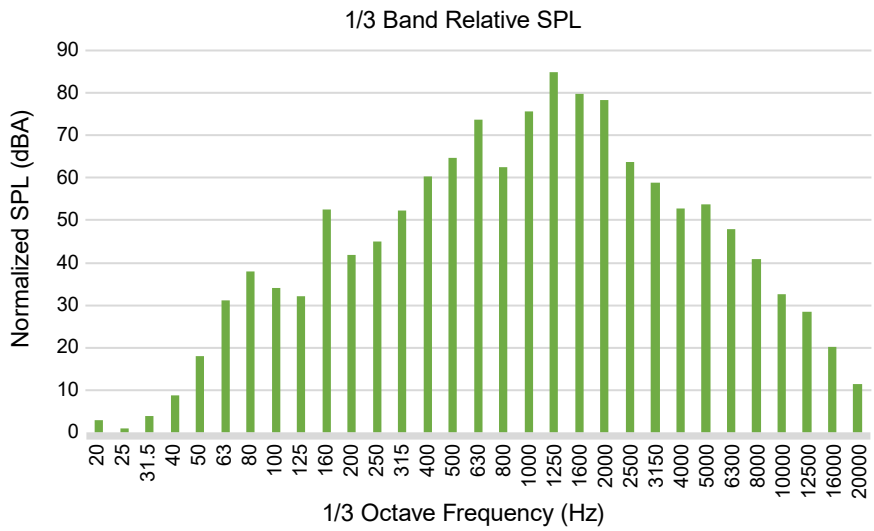

**Figure 2-12 Sound Pressure Spectral Distribution (Normalized for 20 Hz SPL as 1 dBA) (For 1.5T: SIGNA Champion)**

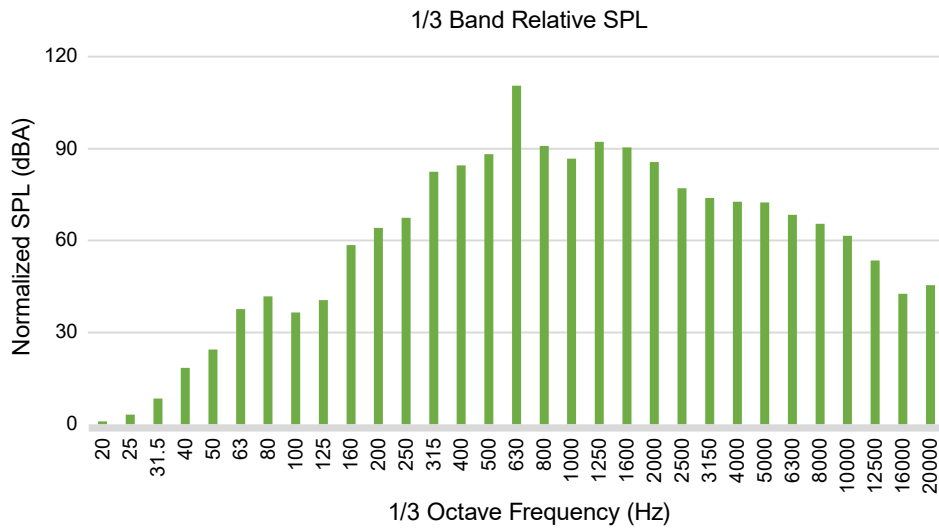

**Figure 2-13 Sound Pressure Spectral Distribution (Normalized for 20 Hz SPL as 1 dBA) (For 1.5T: SIGNA Sprint)**

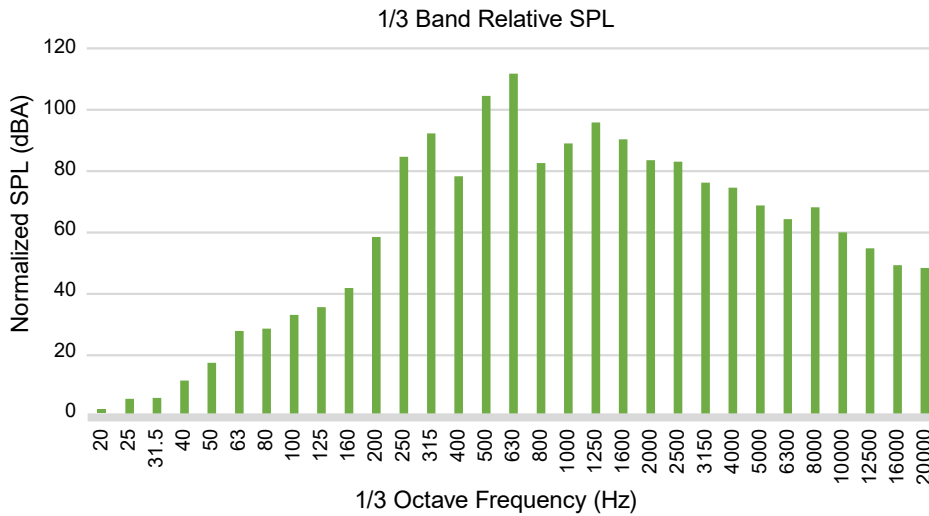

**Figure 2-14 Sound Pressure Spectral Distribution (Normalized for 20 Hz SPL as 1 dBA) (For 1.5T: SIGNA Sprint Select)**

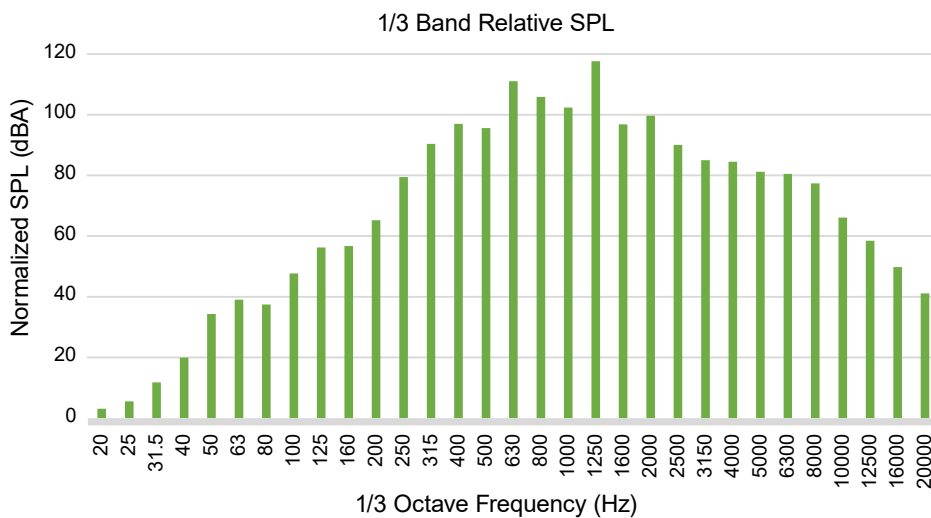

**NOTE**

The vertical axis does not represent the actual SPL. Use the dB difference between frequency as a reference.

**NOTE**

The MR product clinical operation will generate sound pressure proportional to the specific clinical application. The entire spectra (envelope) shown above in figures 1 through 14 represents the relative 1/3 band octave sound pressure the MR scanner may transmit into the air.

See [Acoustic Background and Design Guidelines on page 15](#) for acoustic design information.

## 3 Acoustic Background and Design Guidelines

### 3.1 Acoustic Background

The acoustic information is provided for site planning and architectural design activities to address acoustics to meet local regulations and customer requirements. For more information about recommended safety procedures regarding patient exposure to MR generated acoustic levels, see the MR Safety Guide included with the system Operator Manual.

A typical MR suite has two types of acoustic noise issues:

- Acoustics within the rooms in which the patients and technicians are impacted by the noise of the MR System as the system scans
- Noise transmitted to other spaces through airborne and structure-borne paths. Refer to the system Preinstallation Manual for details on structure-borne acoustic management.

### 3.2 Airborne Acoustic Background

The airborne transmission path entails the excitation of air within the Magnet Room; the resonator module consisting of the magnet, RF coil, and gradient coil generates acoustic noise similar to an intense loud speaker. The airborne noise passes through walls through any openings (for example, small holes, cracks, HVAC ducts, and waveguides) into surrounding spaces within, and possibly beyond, the confinements of the building. Acoustic energy can transmit across distances of significant length.

Examples of airborne acoustics issues may include the following (not limited to only these) :

- MR Operator exposure at Operator Workstation (For example, Operator viewing in-line with the patient inside the magnet may require a higher acoustic attenuation window.)
- Image reading rooms adjacent to Magnet Room (may be separated by hallways)
- Secretarial, offices, meeting rooms, patient rooms (ICU, exam, primary care, and so on)
- Adjacent residential areas or spaces
- In-house library facilities

### 3.3 Structure-borne Acoustic Background

The structure-borne transmission path is the result of mechanical excitation of the floor or building structure causing the building to vibrate. The vibration of the surfaces at surrounding spaces then radiates as acoustic noise. Acoustic energy can transmit across distances of significant length.

#### NOTE

Less than 5% of installed base sites have experienced structure-borne acoustic issues.

Examples of structure-borne acoustic issues may include the following (not limited to only these):

- Areas directly above or below the Magnet Room (may not always be an issue)
- Image reading rooms adjacent to Magnet Room (may be separated by hallways)

- Secretarial, offices, meeting rooms, patient rooms (ICU, exam, primary care, and so on)
- Adjacent residential areas or spaces
- In-house library facilities

## 3.4 Acoustic Design Guidelines for the Magnet Room

Noise generated by the MR System is inherent to the operation of the system. The sound quality (human perception) within the Magnet Room can be modified by including sound absorbing materials to make the room sound more subdued and less harsh by absorbing sound energy at some frequencies, while not impacting the overall sound level.

- Use ceiling tiles with fiberglass panels having a 51 mm (2 in.) thickness set into the standard T-bar grid system.
- Adding fiberglass panels to the side walls covering approximately 20% of the side wall surface area. The panels should focus on covering the top half of the side walls. Panels could take many different and decorative shapes to improve the sterile look of the rooms. Typically panels might be on the order of 1.2 m x 1.8 m (4 ft. x 6 ft.) with a thickness of 102 mm (4 in.) or equivalent. Panel shape could vary to produce mosaic effects to meet the customer preference. Any decorative materials used to cover the wall panels must be porous so that sound waves can pass through with ease. In principle, a person should be able to breathe through the material with ease. Fire retardant cloth should be used. The NRC (Noise Reduction Coefficient) of the panels should be 0.95 or better when mounted against a hard surface such as drywall or concrete.

## 3.5 Acoustic Design Guidelines for Inter-spacial Areas

Make sure the magnet room construction provides adequate suppression of acoustic noise and mitigation of potential coupling of the building to structure vibrations (1 Hz to 4 kHz) actuated by the magnet feet so that acoustic exposure outside of the magnet room does not exceed 85 dBa or the limit derived from local regulations.

Acoustic noise control to mitigate noise from being transmitted to other spaces often amounts to paying attention to small details while working with ordinary construction materials. The key objectives are to eliminate all cracks and gaps in the wall construction while making sure that the doors, walls, floor, and ceiling have adequate transmission loss through mass or special double wall construction, along with good fitting massive doors.

The entire magnet must be surrounded by walls with substantial mass and/or double wall construction so that noise is contained in the room and not allowed to pass through into nearby spaces. Wall junctions must be sealed with acoustical sealant so that noise waves do not escape from the room. In principle, if the room were filled with smoke and under a positive pressure, no smoke would leak from the room.

## 3.6 Wall Construction

Wall Construction will entail ordinary building materials in a careful configuration.

- The preferred wall construction should have a Weighted Sound Reduction Index (Rw) rating of 46 or an ASTM Sound Transmission Coefficient (STC) of 50. This entails the use of standard wall construction of steel studs (typically 92 mm (3-5/8 in.)) with 2 layers of Type X drywall (typically 16 mm (5/8 in.)) on each side (a total of 4 layers) and fiberglass batt in the stud cavity. All drywall must be overlapped by 152 mm (6 in.) or more. Beads of (USG) acoustical

caulking (non-hardening) would be used around the entire perimeter of the drywall. Any form of wall penetration should be avoided. Any necessary wall penetrations must be sealed using combination of acoustical caulking (non-hardening) and fiberglass batt material. See [Figure 3-1 Example Of Wall Construction For Airborne Noise Control - Option 1](#) and [Figure 3-2 Example Of Wall Construction For Airborne Noise Control - Option 2](#).

- The top of the wall must join the ceiling or floor above so that no cracks or gaps occur. If metal pan is used on the ceiling or floor (above), then flute seals would be used to seal the gaps between the drywall and the pan. Alternately, drywall can be cut out to fit into the flutes. Acoustical caulking (non-hardening) will be used to seal the remaining cracks and gaps.

**Figure 3-1 Example Of Wall Construction For Airborne Noise Control - Option 1**

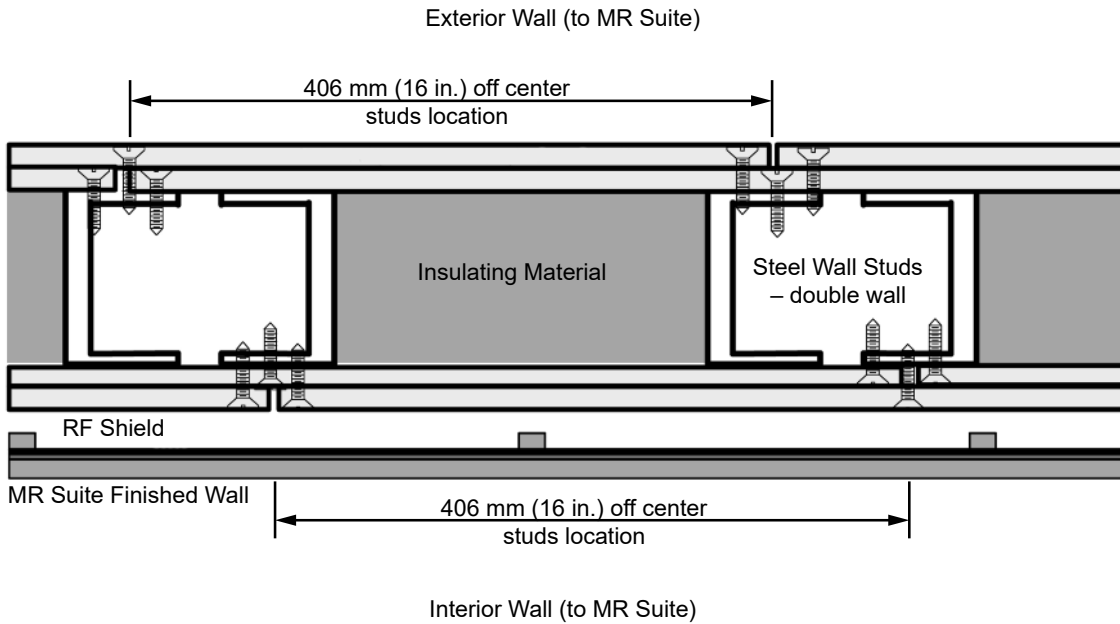

**Figure 3-2 Example Of Wall Construction For Airborne Noise Control - Option 2**

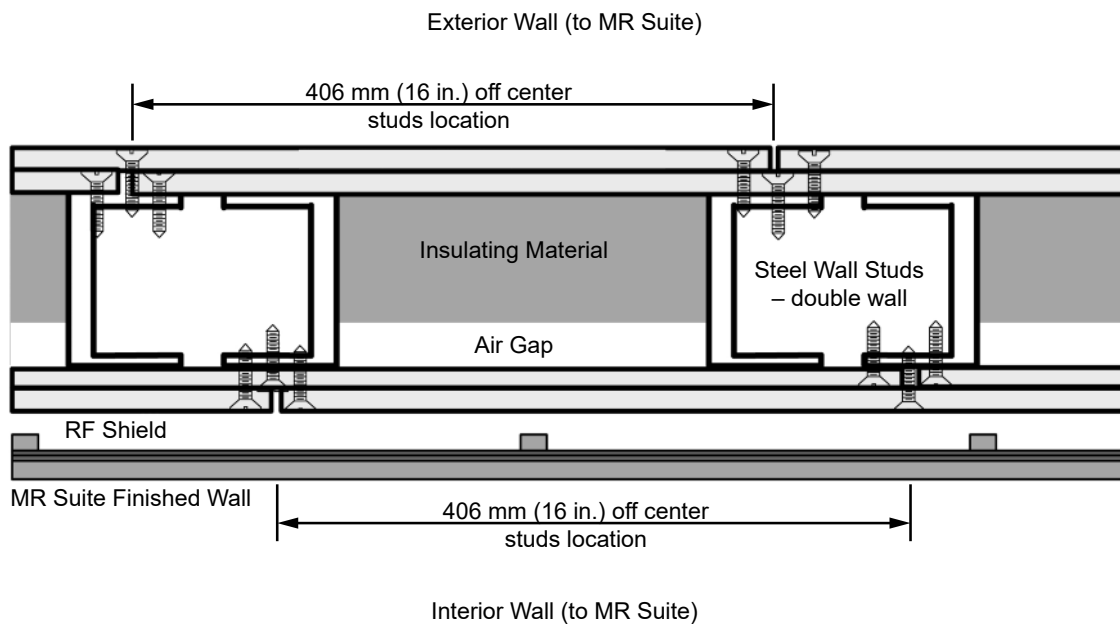

## 3.7 High Bay RF Room

A high bay RF Room is a self-contained RF Room which has open air space between the RF Room ceiling and the building floor above. The air space is an acoustic transmission path. Acoustic energy must be reduced to minimize this transmission of energy through this path.

In cases where the magnet is to be installed in a high bay, it may be most effective to enclose the RF Room with its own drywall and steel stud room. The key difference being a ceiling assembly that mimics the sidewall construction to contain noise.

- Normal high STC stud walls from above would be used to support a ceiling assembly constructed of structural C channel with two layers of drywall on each side (a total of 4 layers) with fiberglass batt in the cavity.
- Penetrations should be avoided through the use of surface mounted lights. HVAC and ducts passing through the ceiling, party wall or side walls would require acoustic noise attenuation in the form of inline silencers. Gaps and cracks would be sealed between the ceiling, party wall or vertical side walls and the cryogen vent plumbing. In essence the magnet would be enclosed in a drywall "doghouse."

## 3.8 Miscellaneous Plumbing, RF Windows and RF Doors

Other construction details are equally important to mitigate noise transmission to meet the intended goal.

- Pipes (gas or water) and electrical conduit or Magnet Room signal cables must be sealed where they penetrate the walls or ceiling. A heavy mastic material such as Duxseal™ is appropriate.
- RF windows should be purchased as window or frame units with an STC rating obtained from laboratory testing per ASTM standards. Rw 46 (STC 50) windows are needed. The installation must include correct sealing to avoid sound leaks.
- RF doors should be selected to provide Rw 46 (STC 50) to quell the noise. Contact the RF Shield Room supplier for selection of RF doors that meet the local acoustic codes and site acoustic requirements. RF door seals must be selected to prevent small gaps around the door perimeter and at the door threshold. RF door seals would either require periodic replacement or a door seal that would last the life of the Magnet Room.

## Revision History

English Document review and approval per DOC2348786		
Rev	Date	Description
Rev 8	November 2025	Table 2-1: Added product names "SIGNA Bolt" and "SIGNA MAGNUS" Figure 2-3: Added product name "SIGNA MAGNUS" Added new Figure 2-4 for SIGNA Bolt Added new Figure 2-14 for SIGNA Sprint Select Section 3.5: Added new first paragraph
Rev 7	April 2025	Table 2-1: Added product name "SIGNA Sprint" Table 2-2: Added product name "SIGNA Sprint" Figure 2-11: Removed product name "SIGNA Winner" Added new Figure 2-12 for SIGNA Sprint
Rev 6	October 2024	Figure 2-2: Add product name "SIGNA Performer" and "SIGNA Pilot"
Rev 5	March 2024	Figure 2-11: Add product name "SIGNA Winner"
Rev 4	October 2023	Table 2-1: Added product "SIGNA Prime MAX, SIGNA Prime Elite" Added new Figure 2-6 for SIGNA Prime MAX, SIGNA Prime Elite Added new Figure 2-11 for SIGNA Champion
Rev 3	October 2022	Table 2-1: Added product "SIGNA Victor, SIGNA Aviator AIR and SIGNA Star AIR" Table 2-2: Added value for Artist Evo Added new Figure 2-6 for SIGNA Victor/SIGNA Aviator AIR/ SIGNA Star AIR Added new Figure 2-8 for SIGNA Artist Evo
Rev 2	August 2021	Added product "SIGNA Hero" to title of Figure 2-2 Added product "SIGNA 7.0T" to content of Table 2-1 and Table 2-2 Added product "SIGNA 7.0T" to title of Figure 2-4
Rev 1	July 2020	Initial Release of 5850262-1EN based on DOC2348786, Rev. 2



GE HealthCare

[www.gehealthcare.com](http://www.gehealthcare.com)